



13 Keir Crescent

, Wishaw, ML2 7JY

£600 Per month

Viewing

Please contact our Pomphreys Properties Ltd Office on 01698373365 if you wish to arrange a viewing appointment for this property or require further information.



2



1



1



Floor Plan

13 Keir Crescent, Wishaw

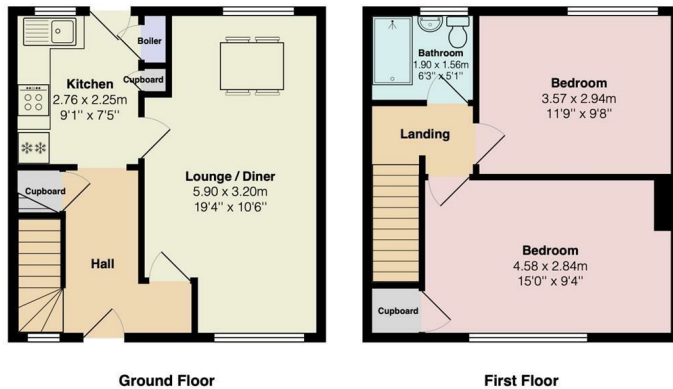

Total Area: 65.7 m² ... 707 ft²

All measurements are approximate and for display purposes only



Area Map



Energy Efficiency Graph



These particulars, whilst believed to be accurate are set out as a general outline only for guidance and do not constitute any part of an offer or contract. Intending purchasers should not rely on them as statements of representation of fact, but must satisfy themselves by inspection or otherwise as to their accuracy. No person in this firms employment has the authority to make or give any representation or warranty in respect of the property.